

Lake Tabourie holiday park



price list & brochure 2017/18

Just south of Ulladulla you'll find Lake Tabourie Holiday Park. Situated between the lake and the beach, it is an ideal base for exploring Pigeon House Mountain and surrounding National Parks.

- Beachfront cabins
- Organised group accommodation
- Waterfront campsites
- Powered ensuite sites
- Sites for large RVs off-peak
- Full-size tennis court
- Camp kitchen & BBQ facilities
- BMX pump track
- Free WiFi access
- Aquatic splash pad
- Two playgrounds and jumping pillows
- Function venue
- Mini golf
- Summer holiday activities
- Pet-friendly camp sites – off-peak only
- Canoe and SUP hire

Bookings: 1300 559 966

Lake Tabourie Holiday Park

Contact our managers

F595A Princes Highway
Lake Tabourie NSW 2539

Ph/Fax 02 4406 3101

Email tabourie@holidayhaven.com.au
Web laketabourie.holidayhaven.com.au

Relax. Enjoy. Explore.

www.holidayhaven.com.au



SHOALHAVEN SOUTH COAST NSW



booking terms & conditions

Effective from 1 July 2017. GST included. Prices and information subject to change without notice.

- Maximum 4 adults per cabin.
- 17 years and under stay free all year round.
- Bookings on any site or in any cabin in the park shall not exceed 30 consecutive nights.
- Persons under 18 (or persons on their behalf) are not permitted to make reservations. Unaccompanied minors will not be accepted as guests in the park.
- 1 car space is allocated per site booked. Additional vehicles unless otherwise arranged with park management must be parked in allocated visitor parking or outside the park.
- For un/powerd sites only ground sheets made of shade cloth or open weave material are permitted.
- Strictly 1 tent or 1 caravan or 1 campertrailer per site.
- All damages to park property will be charged to the client's credit card.
- There is no smoking permitted in proximity to park accommodation or other buildings, including on cabin decks and building verandas.

Dog Policy

- Selected sites only – Dogs welcome upon application to the park manager. Not available in peak season or school holidays. Conditions apply.

Booking Periods

- Peak Season –
October – 29/09/17 – 1/10/17 (3 nights)
Christmas – 25/12/17 – 27/01/18
Easter – 30/3/18 – 2/4/18 (4 nights)
- Low Season – All other times
- Sites/Cabins are booked from 2pm (check in) on day of arrival until 10am (check out) on day of departure unless otherwise stated or arranged prior with park management, fees may apply
- Minimum bookings may apply during some booking periods

Payment and Deposits

- Guest credit card details are required to secure all bookings.
- Bookings are not transferable to other persons.
- Deposit of at least 1 night's tariff is required at time of booking for all off-peak stays. Balance must be paid in full on or before arrival.
- Peak Summer Period Bookings Payment – Deposit of up to 1 night's tariff is required at time of booking. 50% of balance to be paid by 1 August 2017. Booking must be paid in full by 1 November 2017.
- Peak Easter Period Bookings Payment – Deposit of up to 1 night's tariff is required at time of booking. 50% of Balance to be paid by 1 September 2017. Full amount must be paid by 1 March 2018.
- Peak October Long Weekend – Deposit of 50% of tariff is required at time of booking. Full amount must be paid by 1 September 2017.

Cancellations and Refunds

- Park Management reserves the right to cancel or amend any bookings.
- Cancellation fee of up to the first night's tariff will be applied to all bookings when more than 30 days' notice is given.
- Please choose your booking dates carefully REFUNDS ARE NOT AVAILABLE FOR bookings cancelled less than 30 days before arrival or due to early departures, no shows, change of mind, inclement weather, or where clients are asked to leave the park for breaching park rules.

Additional Fees and Charges

- Additional charges may apply for extra guests
- Cleaning Fee – A minimum of \$100 may be charged if cabin/site left in unsatisfactory condition upon departure.
- Early and late departure fees may apply for arrivals before 2pm and departures after 10am

cabin plans

Beach House

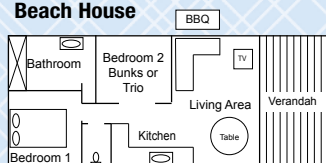

Tabourie Deluxe

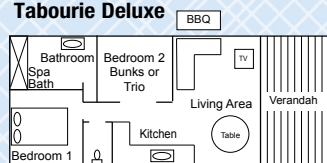

Tabourie

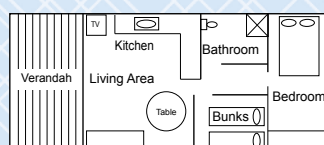

Sandpiper



Cabin plans are a guide only and are not to scale. There may be some variations.

price list 2017/18

	Single night Low season	Low per night	Peak per night	Occupant inclusions	Extra Adult
CABINS					
BEACH HOUSE (17, 20, 21, 22, 23) Sleep 6 Front row cabin with views to beach and island. 8 x 2 bedroom cabins with TV, DVD, A/C, ceiling fans, dishwashers, kitchen, queen bed, 2 x single bunks, linen and towels included. BBQ, deck, water views, dishwasher.	230	200	320	2 adults & up to 4 children	25
BEACH HOUSE (18, 19, 24) Sleep 5 Front row cabin with views to beach and island. 8 x 2 bedroom cabins with TV, DVD, A/C, ceiling fans, dishwashers, kitchen, queen bed, trio bunk bed. linen and towels included. BBQ, deck, water views, dishwasher.	230	200	320	2 adults up to 3 children	25
TABOURIE DELUXE (11, 12, 25) Sleep 6 Large family cabins, close to the beach, some with beach views. 5 x 2 bedroom cabins with TV, DVD, A/C, ceiling fans, kitchen, dishwasher, spa bath, queen bed, 2 x single bunks, linen and towels included. BBQ, deck.	200	170	270	2 adults & up to 4 children	25
TABOURIE DELUXE (15, 16) Sleep 5 Large family cabins, close to the beach, some with beach views. 5 x 2 bedroom cabins with TV, DVD, A/C, ceiling fans, kitchen, dishwasher, spa bath, queen bed, trio bunk beds, linen and towels included. BBQ, deck.	200	170	270	2 adults & up to 3 children	25
TABOURIE DOUBLE (14, 5) Sleeps 2 Cabin for two. 1 x cabin with TV, DVD, A/C, ceiling fans, kitchen, queen bed, linen and towels included. Deck.	100	95	180	Maximum 2 adults	N/A
SANDPIPER (4). Sleeps 5 Great family cabin, close to aquatic play area. 4 x 2 bedroom cabin with TV, (DVD), A/C, ceiling fans, kitchen, double bed, double/triple bunk, linen to all beds included, towels. Deck.	150	135	225	2 adults & up to 3 children	20
SANDPIPER (1, 2, 3). Sleeps 4 Great family cabin, close to aquatic play area. 2 bedroom cabin with TV, A/C, ceiling fans, kitchen, queen bed, bunk, linen to all beds included, towels. Deck.	150	135	225	2 adults & up to 2 children	20
TABOURIE (6-9) Family cabin a short stroll to the beach. 4 x cabins with TV, DVD, A/C, ceiling fans, kitchen, double bed, triple bunk, linen to all beds included, towels. Deck. Sleeps 5.	115	95	190	2 adults & up to 3 children	20
BUNKROOMS Situated close to the lake and amenities with their own camp kitchen, ideal for groups. 10 x small cabins each with 2 x triple bunks. They have tea and coffee making facilities, a microwave, toaster, small fridge and sink in the cabin. Guests are required to bring their own bedding and towels, use the amenities for showers etc. and the camp kitchen for cooking. Sleeps up to 6.	75	75	140	up to 6 people	0

Late check out Sunday up until 3pm, subject to availability.

Seasonal specials and mid-week discounts may apply throughout the year. Please enquire with reception.

SITES	Low season	Peak season	Occupant inclusions	Extra adult
ENSUITE	50	90	2 adults & up to 4 children	20
POWERED SITE	35	75	2 adults & up to 4 children	20
UNPOWERED SITE	25	60	2 adults & up to 4 children	20



Relax. Enjoy. Explore.



lake tabourie holiday park

local attractions and activities

- Crampton Island
- Rock, beach and lake fishing
- Surrounding bushland abounds with bird and other wildlife
- Bushwalking – especially to the famous Pigeon House Mountain/Didthul
- Kiosk – open during peak season
- BMX pump track
- Half basketball court
- Scenic lookouts
- Canoe hire
- Stand-up paddle board hire
- 10 minutes to Ulladulla;
30 minutes to Batemans Bay



HH012 05/17

